

The information contained in this drawing is the sole property of HMS Industrial Networks AB. Any reproduction in part or whole without the written permission of HMS Industrial Networks AB is prohibited

Rev.	Description	Date	Sign
1.3		2013-05-03	RiA
1.4	Added support for pins and HMS logotype	2013-09-30	RiA
1.5	Added pcb-outline to pcb-layout	2014-05-05	RiA

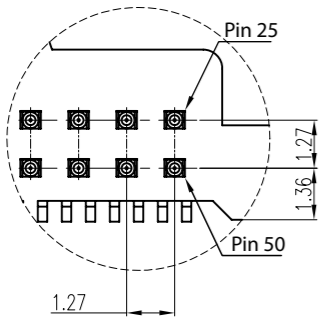

DETAIL C
SCALE:5:1

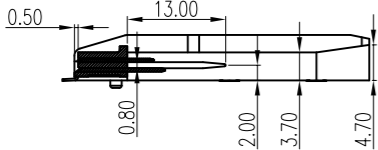

SECTION: B-B

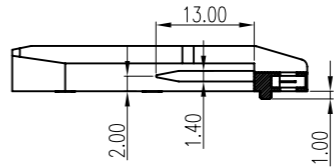
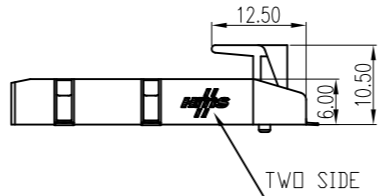
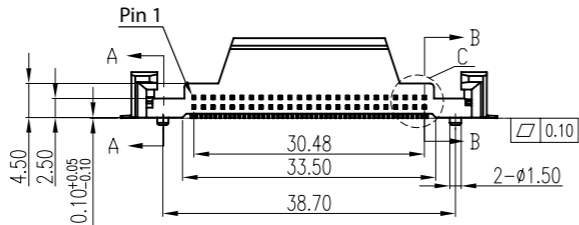
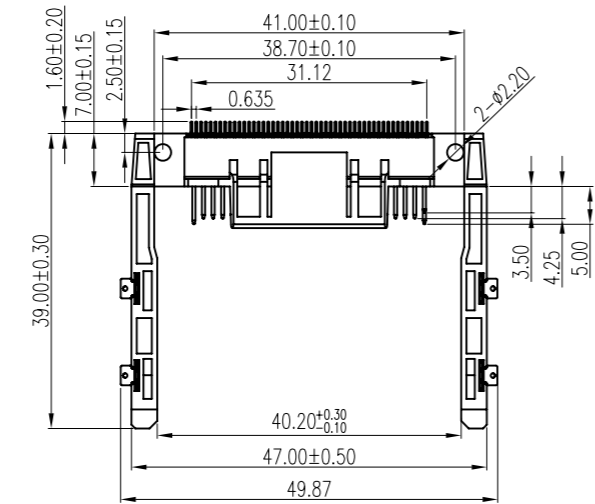

SECTION A-A

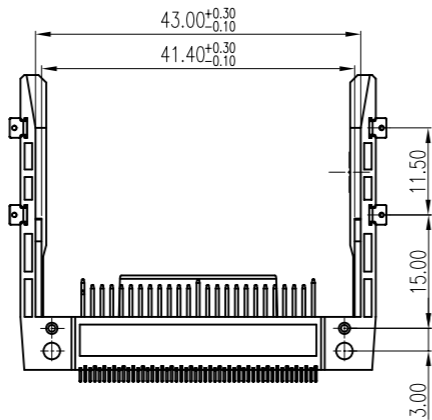

Recommended PCB-layout
General tolerances $\pm 0,05\text{mm}$

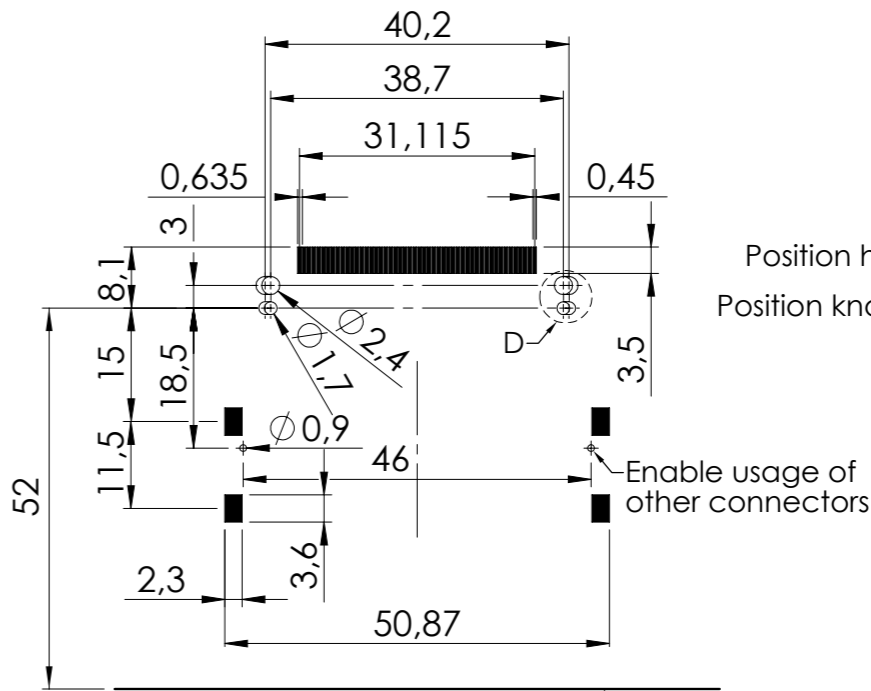

Enable usage of
other connectors
(Second Source)

Position hole
Position knob

Enable usage of
other connectors

DETAIL D

Note:

1. Housing: LCP(Liquid Crystal Polymer)
Color:Natural,Thermoplastic,UL 94 V-0
2. Contact: Copper Alloy
3. Operation voltage: 100 VAC max
4. Current rating: 0.5 Amp.
5. Contact resistance: 40m ohms max.
6. Insulation resistance: 1000M ohms min 500 VDC.
7. Dielectric withstanding voltage: 500VAC/1minute.
8. Operating Temperature: -40° C to +85° C
9. Resistance to Solder Heat :
Temperature: 260° C
Immersion duration: 10sec.
- 10.Durability: 5000 Cycles
- 11.Finish/Plated:
Terminal:15u" min Au Plated on Contact Area,
100u" min Tin Plated on solder area,
50u" min Ni Under Plated over all
Grounded Pin: 80u" min Tin Plated on solder area,
50u" min Ni Under Plated over all
- 12.RoHS and REACH compliant
- 13.Storage -25 - 65°C, 0 - 90% RH

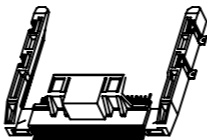

Owner
HMS Industrial Networks AB
Stationsgatan 37
S-302 45 Halmstad
Tel: +46 (0)35 - 17 29 00
Fax: +46 (0)35 - 17 29 09

DIM.	TOL.	DIM.	TOL.
X.	$\pm 0,30$	X.	$\pm 2,00^\circ$
X,X	$\pm 0,25$	X,X	$\pm 1,0^\circ$
X,XX	$\pm 0,15$	X,XX	$\pm 0,5^\circ$
X,XXX	$\pm 0,10$	X,XXX	$\pm 0,2^\circ$

Scale
1:1

Size

Weight

Finishing

Title
Compact Flash connector HMS

Sign:
RiA

Date:
20120313

Rev.
1.5

Sheet:
1 of 1

Document nr
SDH-7018-202

HMS nr
SP1137