

# Trunk Gender Changers

- Male-to-female
- Female-to-male, straight and 90° versions

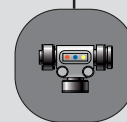

- Phosphor bronze contacts for greatest reliability
- Variety of male-to-female and female-to-male connection options for maximum installation flexibility



Gender changers are handy tools to change the connection interface from male to female or vice-versa. One version allows for the conversion of a female cordset to a male receptacle while another version allows for the conversion of a male cordset to a female receptacle. The right angle version is specifically designed for tight spaces where a tee connection will not fit such as bus IN/OUT connections on active modules or where a molded right angle connection on a molded cordset made to a specific length is not available for an immediate field need.

## Gender Changers

FACE VIEWS	TRUNK MALE	TRUNK FEMALE
FIG	CHANGES FEMALE CONNECTOR END TO MALE	
1 AND 4	115060A	
FIG	CHANGES MALE CONNECTOR END TO FEMALE	
2 AND 4	115010A	
FIG	CHANGES STRAIGHT CONNECTOR END TO RIGHT ANGLE	
3 AND 4	115032A	

### CATALOG OPTIONS

Use the following chart to modify your part's specifications

115060A

COUPLING NUT	
EPOXY COATED ZINC . . . . .	A
STAINLESS STEEL . . . . .	SS
NICKEL-BRASS . . . . .	NB

**MECHANICAL**

CONNECTOR FACE: THERMO PLASTIC ELASTOMER  
 MOLDED BODY: THERMO PLASTIC ELASTOMER  
 COUPLING NUT: ZINC DIECAST, BLACK E-COAT – STAINLESS STEEL, NICKEL-PLATED BRASS OPTIONAL

**ELECTRICAL**

VOLTAGE RATING: 50V  
 AMPERAGE: 8A  
 CONTACT MATERIAL: PHOSPHOR BRONZE ALLOY  
 CONTACT PLATING: GOLD OVER NICKEL

**ENVIRONMENTAL**

PROTECTION: IP67  
 AMBIENT OPERATING TEMP: 4° TO 176° F (-20° TO 80° C)

### DIMENSIONS

Female Cordset to Male Receptacle

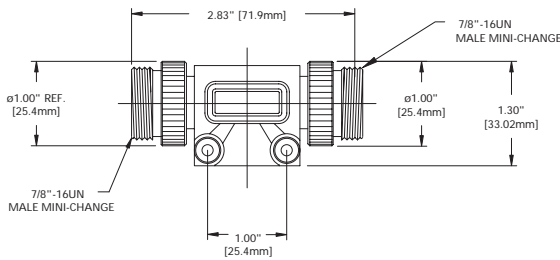

FIG 1

Male Cordset to Female Receptacle

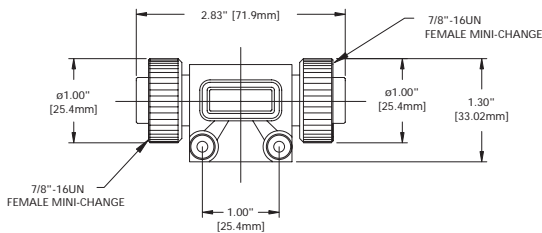

FIG 2

90° Male to Female Connector

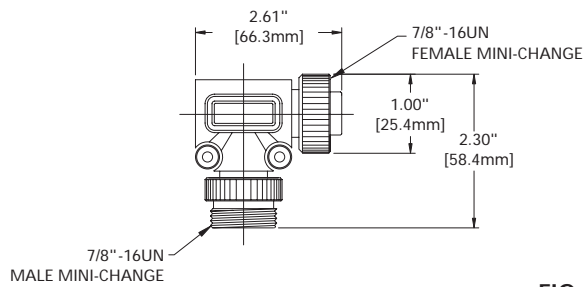

FIG 3

### SCHEMATIC

Gender changers

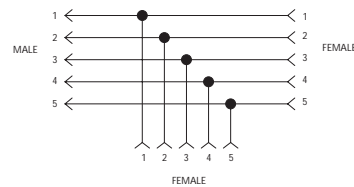

FIG 4