

Site-Eded Cordsets

- Single-ended male straight and 90°
- Single-ended female straight and 90°

Single-ended cordsets can be used in a variety of applications. Profibus cordsets are designed to connect one node to the next, with the flying lead end being connected to either a remote Profibus I/O card or a field-attachable Micro-Change® connector, providing quick-disconnects on both ends. Male connectors are supplied with externally threaded coupling nuts while female connectors are supplied with internally threaded coupling nuts. This enables the end user to daisy chain data lines in a variety of configurations.

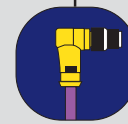

- PUR jacketed for chemical and oil resistance
- Low-resistance contact design
- Leaded end allows for easy field termination
- 360° shielded head design to reduce RFI/EMI



Site-Eded Cordsets

FACE VIEWS	MALE	FEMALE
COLOR CODE	1 - NOT USED 2 - GREEN(BUS-A)	3 - NOT USED 4 - RED(BUS-B) 5 - SHIELD
VOLTAGE	250V AC / DC	
CURRENT	4A	
CABLE	#22 AWG	

MALE	FIG	SINGLE-ENDED CORDSETS
STRAIGHT	1	B05S06PP4Mxxx
90°	2	B05S07PP4Mxxx
MATING RECEPTACLE*	5	BR5U70PP4M0103
FEMALE	FIG	SINGLE-ENDED CORDSETS
STRAIGHT	3	B05S00PP4Mxxx
90°	4	B05S01PP4Mxxx
MATING RECEPTACLE*	6	BR5U76PP4M0103

OPTIONS

* See pages 98-101 for additional mating receptacles

Use the following chart to modify your part's specifications

B05S01PP4Mxxx

CONNECTOR CONFIGURATION

STRAIGHT FEMALE	00
90° FEMALE	01
STRAIGHT MALE	06
90° MALE	07

SALE LENGTH

2 METER	020
4 METER	040
5 METER	050
6 METER	060
10 METER	100

* Please call for availability of non-standard lengths

CONNECTOR DIMENSIONS

Male Straight

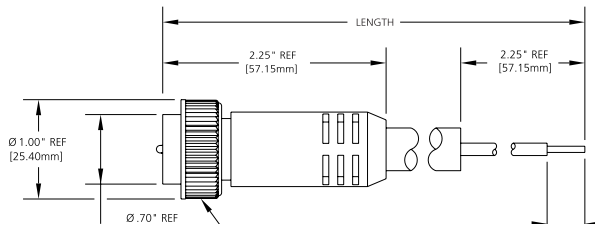

F3

Male 90°

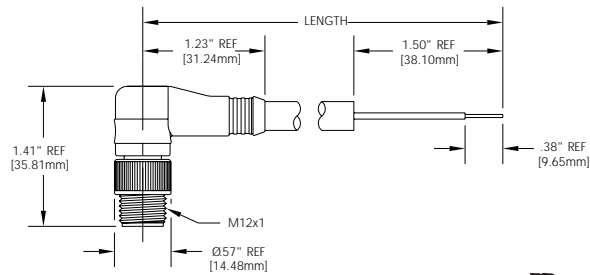

F2

Female Straight

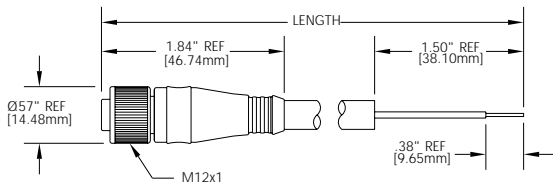

F3

Female 90°

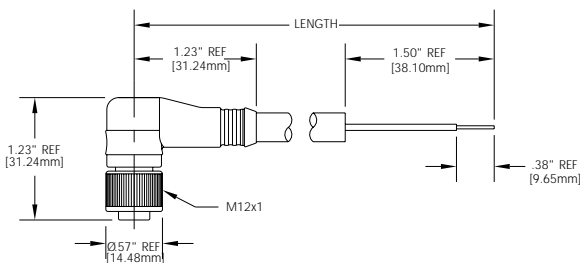

F4

MECHANICAL
 CONNECTOR FACE: NYLON 6/6
 MOLDED BODY: PUR
 O-RING: NITRILE RUBBER
 COUPLING NUT: NICKEL-PLATED BRASS (360° SHIELDED)

CABLE CONSTRUCTION
 OUTSIDE DIAMETER: 8 +/- 0.2mm
CABLE CONSTRUCTION
 JACKET MATERIAL: PUR
 INNER MATERIAL INSULATION: PE INSULATION
 SHIELD TYPE: PETP/AV FOIL, TINNED COPPER BRAID 65%
 CONDUCTOR: TWISTED PAIR 24AWG

ENVIRONMENTAL
 TORSION: SURVIVED MORE THAN 2 MILLION CYCLES AT 360° OVER 1 M
 C-TRACK: SURVIVED MORE THAN 3 MILLION CYCLES AT ACCELERATION 10 M/S² AND PROCESS SPEED OF 5 M/S
 BEND RADIUS: 7.5 X CABLE DIAMETER (STATIC)

ELECTRICAL
 VOLTAGE RATING: 250V AC/DC
ENVIRONMENTAL
 PROTECTION: IP67, NEMA 6
 AMBIENT OPERATING TEMP: -4° TO 176° F (-20° TO 80° C) MOVING

RECEPTACLE DIMENSIONS

Female Receptacle

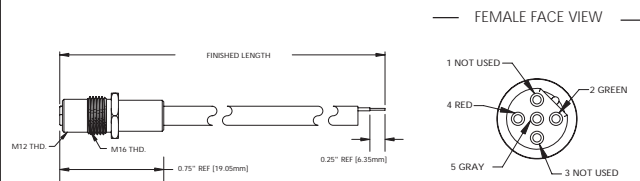

F5

Male Receptacle

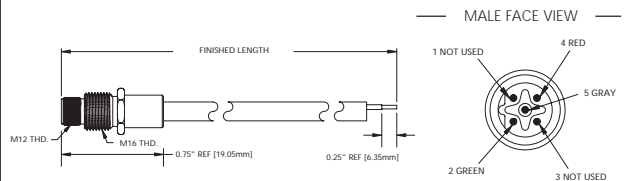

F6